

## PLACA FRONTAL PARA - FRONT PLATE FOR - FRONTPLATTE FÜR DUCATI SCRAMBLER

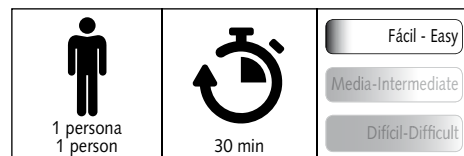

**Ref.: 9177 J**  
(color negro / black colour)

**Ref.: 9177 C**  
(color carbono / carbon look)

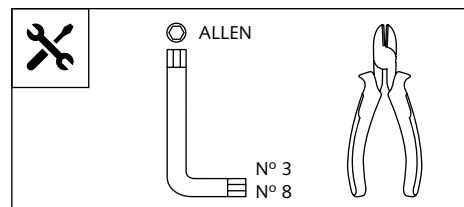

ADAPTABLE A TODOS LOS MODELOS DUCATI SCRAMBLER, EXCEPTO DESSERT SLED.  
ADAPTABLE TO ALL SCRAMBLER MODELS EXCEPT DESSERT SLED

ID	PIEZA / PART	DESCRIPCIÓN	DESCRIPTION	QTY	REF.
1		Placa frontal ABS	ABS front plate	1	10549C/JM3
2		Soporte metálico derecho	Right metal support	1	SOPOR-2P-5-9177
3		Soporte metálico izquierdo	Left metal support	1	SOPOR-2P-5-9177
4		Separador de silicona Ø8x2mm (se suministra montada con las pieza 1)	Ø8x2mm silicone tear (supplied already mounted on item 1)	3	ADHESI-GT-D8---
5		Separador de silicona Ø12,5 x 4mm	Ø12,5 x 4mm silicone tear	1	TOPE-PA12,7X3,5
6		Casquillo Øint. 8,5 X Øext. 13 X 12 mm	Øint. 8,5 X Øext. 13 X 12 mm arrowhead	2	CASQUI-M----769
7		Tornillo Allen M8x35 DIN912	M8x35 DIN912 Allen screw	2	TORNI-AD912-196
8		Silentblock M5	M5 silentblock	2	SILENBTM5-046/1
9		Tornillo Allen M5x15 Ø11 ISO7380	M5x15 Ø11 ISO7380 Allen screw	2	TORNI-I7380-493
10		Arandela de Nylon M5X1	M5X1 Nylon washer	2	ARNV00000000245
11		Tapón tornillo M5 ISO 7380	M5 ISO 7380 Allen screw cap	2	TAPON-----85
12		Ribete autoadhesivo longitud de 210mm, 8mm, espesor 5mm	Self-Autoadhesive Trim length 210mm , 8mm, thickness 5mm	1	PERFIL-PVC-1048
13		Abrazadera cables negra de 3,6x142	3,6x142 cable ties	1	BRIDAN142X3.6-N
14		Kit adhesivos	Stickers set	1	ADHESI-----242

PLACA FRONTAL PARA - FRONT PLATE FOR - FRONTPLATTE FÜR  
**DUCATI SCRAMBLER**

INSTRUCCIONES DE MONTAJE - MOUNTING INSTRUCTIONS - MONTAGEANLEITUNG

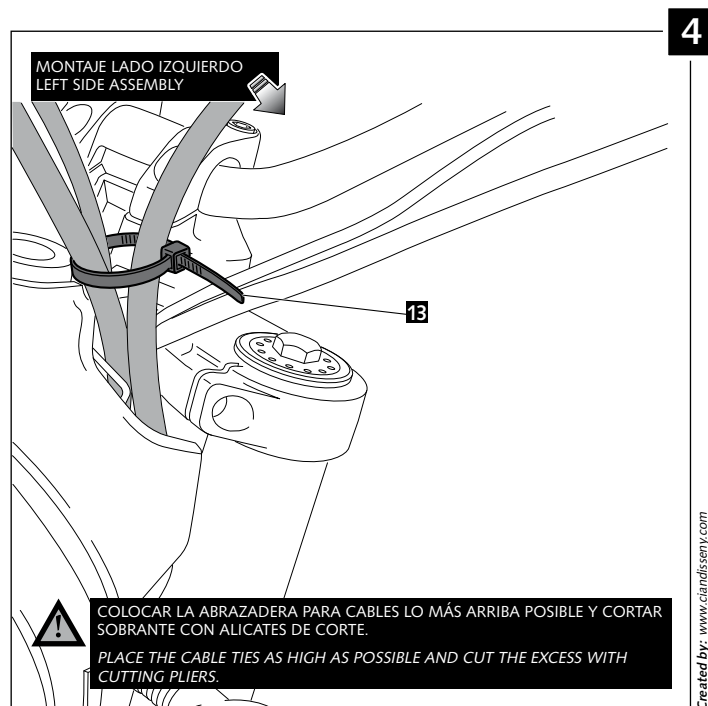
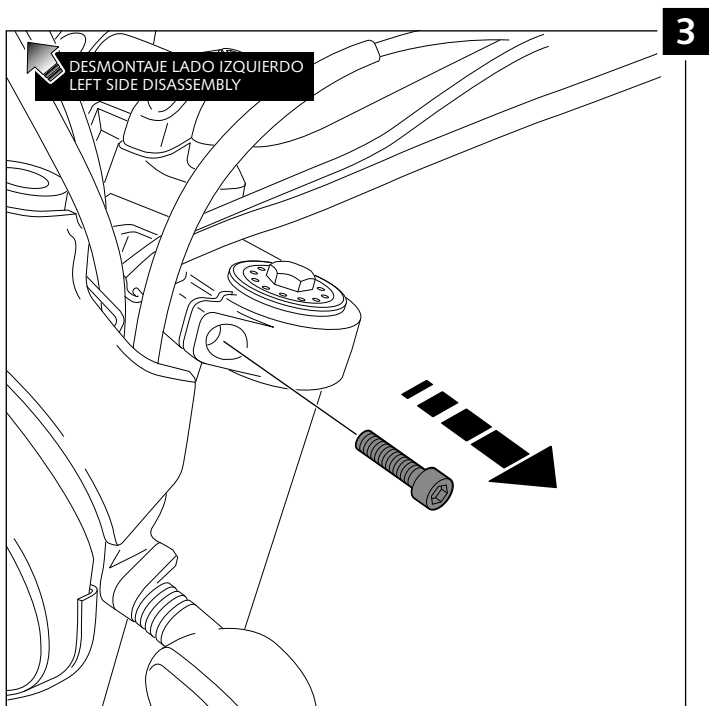
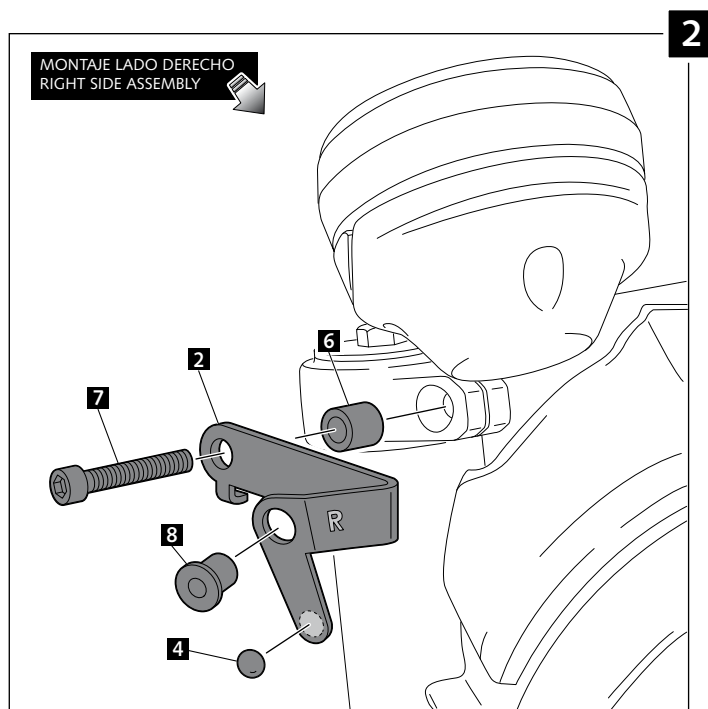
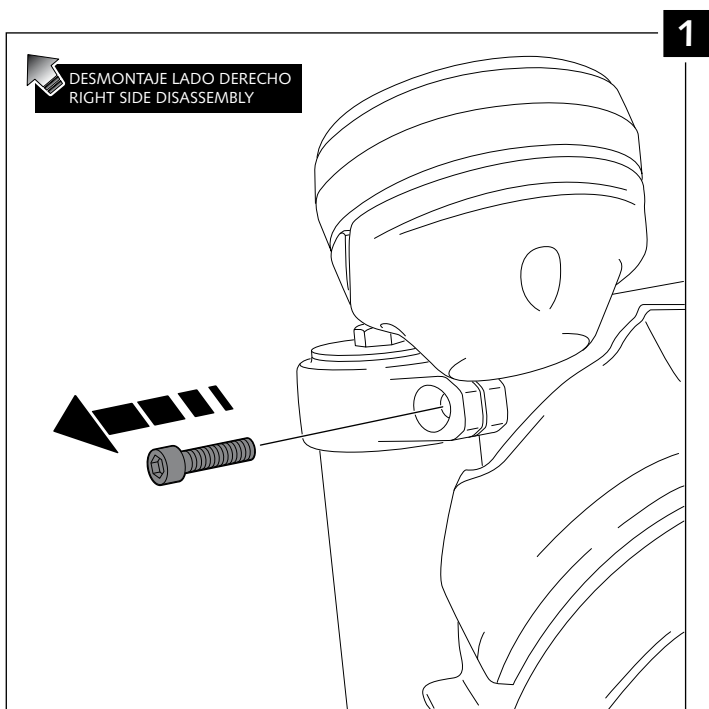

PLACA FRONTAL PARA - FRONT PLATE FOR - FRONTPLATTE FÜR  
**DUCATI SCRAMBLER**

INSTRUCCIONES DE MONTAJE - MOUNTING INSTRUCTIONS - MONTAGEANLEITUNG

